

LSR2300 Series Studio Monitors

Owners Manual

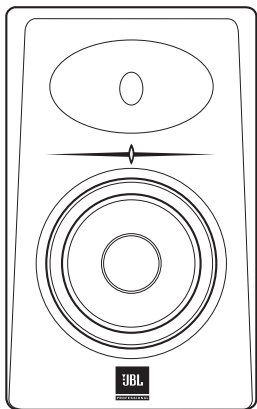

LSR2325P
5" Two-Way Bi-Amplified
Studio Monitor

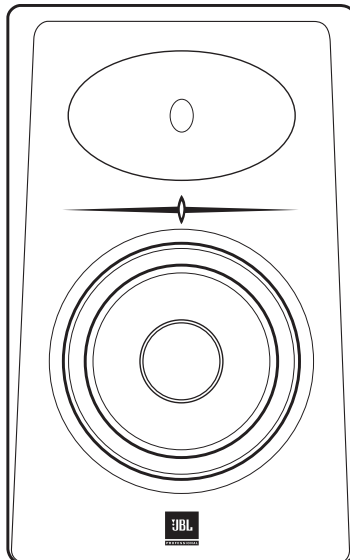

LSR2328P
8" Two-Way Bi-Amplified
Studio Monitor

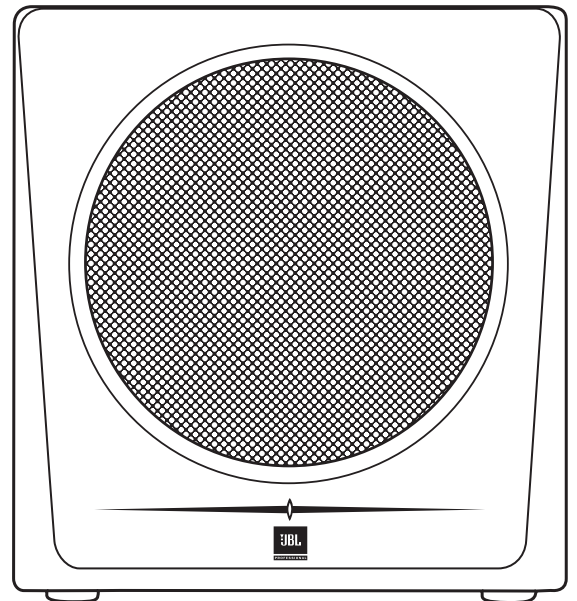

LSR2310SP
10" Powered Studio
Subwoofer

Section 1: Important Safety Instructions

1. Read these instructions.
2. Keep these instructions.
3. Heed all warnings.
4. Follow all instructions.
5. Do not use this apparatus near water.
6. Clean only with dry cloth.
7. Do not block any ventilation openings. Install in accordance with the manufacturer's instructions.
8. Do not install near any heat sources such as radiators, heat registers, stoves, or other apparatus (including amplifiers) that produce heat.
9. Do not defeat the safety purpose of the polarized or grounding-type plug. A polarized plug has two blades with one wider than the other. A grounding-type plug has two blades and a third grounding prong. The wide blade or the third prong is provided for your safety. If the provided plug does not fit into your outlet, consult an electrician for replacement of the obsolete outlet.
10. Protect the power cord from being walked on or pinched, particularly at plugs, convenience receptacles, and the point where they exit from the apparatus.
11. Only use attachments/accessories specified by the manufacturer.
12. Use only with the cart, stand, tripod, bracket, or table specified by the manufacturer, or sold with the apparatus. When a cart is used, use caution when moving the cart/apparatus combination to avoid injury from tip-over.
13. Unplug this apparatus during lightning storms or when unused for long periods of time.
14. Refer all servicing to qualified service personnel. Servicing is required when the apparatus has been damaged in any way, such as power supply cord or plug is damaged, liquid has been spilled or objects have fallen into the apparatus, the apparatus has been exposed to rain or moisture, does not operate normally, or has been dropped.
15. The appliance coupler of the power supply cord is used as the ultimate disconnect device from the mains. The appliance coupler shall remain readily operable.
16. The apparatus shall be connected to mains socket outlet with a protective earthing connection.



Warning:

- To reduce the risk of fire or electrical shock, do not expose the apparatus to rain or moisture.
- The apparatus shall not be exposed to dripping or splashing and no objects filled with liquids, such as vases, shall be placed on the apparatus. As with any electronic product, use care not to spill liquids into any part of the system. Liquids can cause a failure and/or a fire hazard.

Watch For These Symbols

The lightning flash with arrowhead symbol within an equilateral triangle, is intended to alert the user to the presence of uninsulated "Dangerous Voltage" within the products enclosure that may be of sufficient magnitude to constitute a risk of electric shock to persons. The exclamation point within an equilateral triangle is intended to alert the user to the presence of important operating and maintenance Servicing instructions in the literature accompanying the product.



Contents

Important Safety Instructions.....	3
Introduction	5
Setting Up Your System.....	6
Unpacking	6
Placement.....	6
Audio Connections.....	7
Power Connections.....	7
Making Sound	7
LSR2328P, LSR2325P Bi-amplified Studio Monitors	
Front and Rear Views	8
Input Panel.....	9
Audio Connections.....	9
LSR2310SP Powered Studio Subwoofer	
Front and Rear View	10
Input Panel.....	11
Audio Connections.....	11
Setting Subwoofer Level	12
Placement and Polarity	12
Crossover Settings and Bass Management.....	12
Surround Sound and .1 LFE Channel.....	12
Systems Connections - Stereo and Surround Sound Systems.....	13
Appendix A – Mounting of LSR2328P and LSR2325P	16
Appendix B – Trouble Shooting.....	17
Specifications	18
JBL Service Contact Information	20
Product Warranty Information	21

Section 2: Introduction

Congratulations on your purchase of LSR2300 Series Studio Monitors. The LSR2300 Series Studio Monitors meet JBL's high standards for accuracy and long-term reliability in demanding professional applications. All LSR2300 models incorporate JBL professional transducer and network technologies to provide accurate frequency response, exceptional low frequency extension and high SPL capability. JBL LSR Linear Spatial Reference design ensures greater accuracy at the mix position in a broad range of production rooms. Additionally, each speaker is equipped to integrate into professional production systems and work environments.

JBL LSR Linear Spatial Reference Design

Because listening environments vary, JBL designed the LSR2300 system using LSR Linear Spatial Reference design criteria that improves accuracy at the listening position in a broad range of rooms. The key to accuracy is ensuring not just the on-axis sound, but also the reflected sound reaching the mix position is neutral. While most manufacturers take only a single on-axis measurement of the speaker's performance, Linear Spatial Reference design criteria requires 72 measurements, 360 degrees around the speaker, yielding more than 1,200 times more data. This data is used in the design of critical system components, enabling JBL to engineer complete systems that deliver smooth off-axis response. The result: clear accurate sound at the listening position in any room.

The LSR2300 Series includes a range of features to meet the needs of demanding audio production applications.

- LSR2300 low frequency magnetically-shielded transducers are equipped with 1.5" (LSR2328P and LSR2325P) and 2.0" (LSR2310SP) voice coils with robust motor structures to provide excellent low frequency performance. By reducing thermal-related effects, the LSR2300 Studio Monitors sound the same at low, medium and high levels. The woofers are magnetically shielded to prevent interference with magnetically sensitive displays and equipment.
- All models are internally amplified with high-output Class A-B monolithic power amplifiers to provide high SPL (Sound Pressure Level) for demanding production applications.
- The soft dome magnetically-shielded High-Frequency Transducer in the LSR2325P and LSR2328P incorporates optimally damped materials to improve transient response and minimize distortion. By reducing distortion in the lower operating range, where the ear is most sensitive, ear fatigue is reduced.
- A JBL Elliptical Oblate Spheroidal (EOS) Waveguide is precisely engineered to achieve smooth mid and high frequency response for a targeted listening window of $\pm 30^\circ$ horizontally and $\pm 15^\circ$ vertically. This provides greater accuracy at the mix position where the blend of on-axis and reflected off-axis sound is critical. The Elliptical High Frequency Aperture around the tweeter optimizes high frequency coverage for smoother in-room response above 9 kHz
- The LSR2300 series models include balanced XLR, 1/4" and unbalanced RCA connectors, and a variable level attenuator to allow interface to a broad range of signal sources.
- High Frequency and Low Frequency Trim controls in the LSR2328P and LSR2325P allow adjustment of frequency response to preference, or to compensate for acoustically reflective or absorptive listening environments.
- LSR2328P and LSR2325P have integrated mounting points and reinforced enclosures to allow safe wall mounting using readily available, industry-standard mounting brackets.
- The LSR2310SP Subwoofer incorporates a professional bass management system with selectable cross-over settings to optimize low frequency performance in a range of production environments.
- When added to your LSR2300 System, the optional JBL MSC1 Monitor System Controller provides control of your system and JBL RMC™ Room Mode Correction – JBL's ingenious technology that measures and automatically compensates for the effect of low frequency room modes at the mix position that have plagued mix engineers. More information about the JBL MSC1 Monitor System Controller is available at the JBL Professional Website

To get the most out of your JBL LSR2300 system, please review this owner's manual and keep it on hand for future reference. Also, please register your new speakers at www.jblpro.com/registration.

Section 3: Setting Up Your System

Unpacking

When removing the systems from their packaging, it is important not to grasp the units from the front. Because the high frequency device is located near the top of the cabinet on the front baffle, a stray hand or finger can cause damage. The best way to safely unpack your monitors is to open the top of the box, keep the foam end-cap piece on, and roll the box upside down. The box can then be slipped off. This also works in reverse for repacking the units.

Placement

The LSR2328P and LSR2325P models are designed to be positioned vertically to allow the woofer and the tweeter to be in vertical alignment. This orientation eliminates phase shift that occurs when the distance of the woofer to the ear is different from the distance of the tweeter to the ear. Also, the tweeter waveguide is designed to provide optimum dispersion when the system is vertically oriented. Placing the system horizontally will defeat the LSR Linear Spatial Reference principles and cause destructive reflection off the work surface. The loudspeakers should be angled so the center of the high-frequency transducer in each speaker is aimed directly towards the ear of the listener. Ideally, the LSR2328P and LSR2325P speakers should be placed on suitable speaker stands, rather than on the work surface, and positioned away from walls and boundaries. The distance and position of the subwoofer can be adjusted to produce best bass response in the room. Low frequency performance in the room can benefit by placing the subwoofer close to a wall or in a corner that may be further away from the mix position than the other speakers. When properly placed, you should not be able to localize the bass produced by the subwoofer. That is, your ear should believe the bass is coming from the Left and Right speakers.

In two channel production applications, the common listening distance is generally 1 to 1.5 meters (3 to 5 feet) from the left and right speakers. The speakers should be placed so the position of the listener and the two speakers form an equilateral triangle. In 5.1 Surround Sound production, the listening distance for all speakers from any speaker is typically 5' to 8'. The placement of the Left and Right speakers should form an equilateral triangle with the mix position. The Center speaker should be placed half way between the left and right speakers at exactly the same distance from the mix position. The Left Surround and Right Surround speakers should be placed the same distance as the Left, Center and Right speakers, and positioned 110 degrees to 150 degrees relative to the center speaker. The distance and position of the subwoofer can be adjusted to produce best bass response in the room.

2 Channel System with Subwoofer

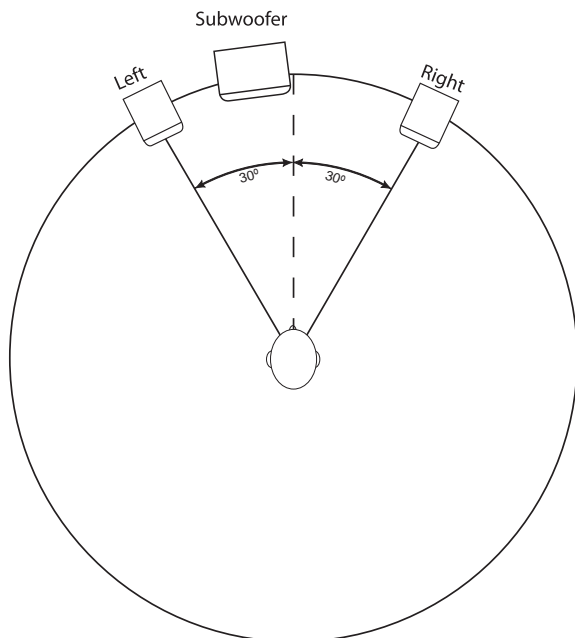

5.1 Surround Sound System

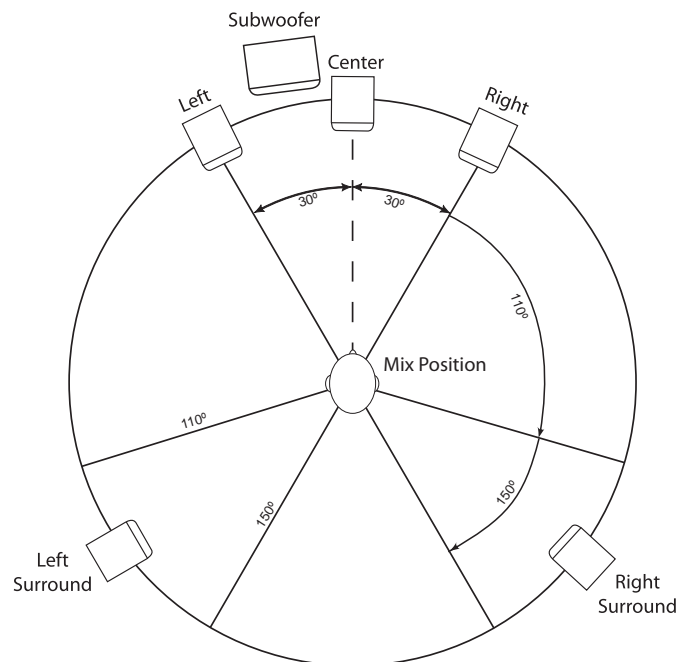

Audio Connections

The LSR2300 Series Speakers are equipped with balanced XLR and 1/4" TRS connectors and unbalanced RCA connectors for connection of professional computer audio interfaces, mixing consoles and audio production equipment as well as unbalanced consumer audio products including personal music players, consumer audio receivers and audio visual equipment.

Connect professional equipment with balanced outputs to the XLR or 1/4" TRS input of the speaker using balanced signal cables. (More information is available www.jblpro.com/lsr click on support.)

Connect consumer equipment with unbalanced outputs to the RCA input of the speaker.

The volume control on the rear of the speaker should be set to achieve the comfortable listening level when the signal source is playing at it's loudest volume. Positive voltage to Pin 2 of the XLR connector, the tip of the 1/4" TRS jack, and the RCA jack will produce a forward motion in the low frequency cone.

Power Connections

The LSR2300 Models include a rear panel voltage selector switch that is set at the factory for the appropriate voltage. Before connecting the power cable it is a good idea to check the position of this switch to confirm the voltage switch is correctly set for the country of use. The power connector on the speaker includes a user-replicable protective fuse. The ground terminal of the IEC plug is required by wiring codes and regulations and must always be connected to the electrical installation safety ground. The LSR2300-Series units have carefully designed internal grounding and balanced inputs and outputs to reduce the possibility of ground loops that produce hum. If hum occurs, see Appendix A for suggested audio signal wiring, system grounding hints and other preventive measures.

Making Sound

After connections are made, reduce the output level of the audio source (mixing console, computer recording system, or preamp) to minimum. Turn on the powered speakers. When the Blue LED on the front of each speaker illuminates, the speakers are ready to reproduce audio signals. Power up all audio equipment. Slowly advance the volume control of connected audio equipment to achieve a suitable listening level, and enjoy.

Section 4: LSR2328P and LSR2325P Bi-amplified Studio Monitors

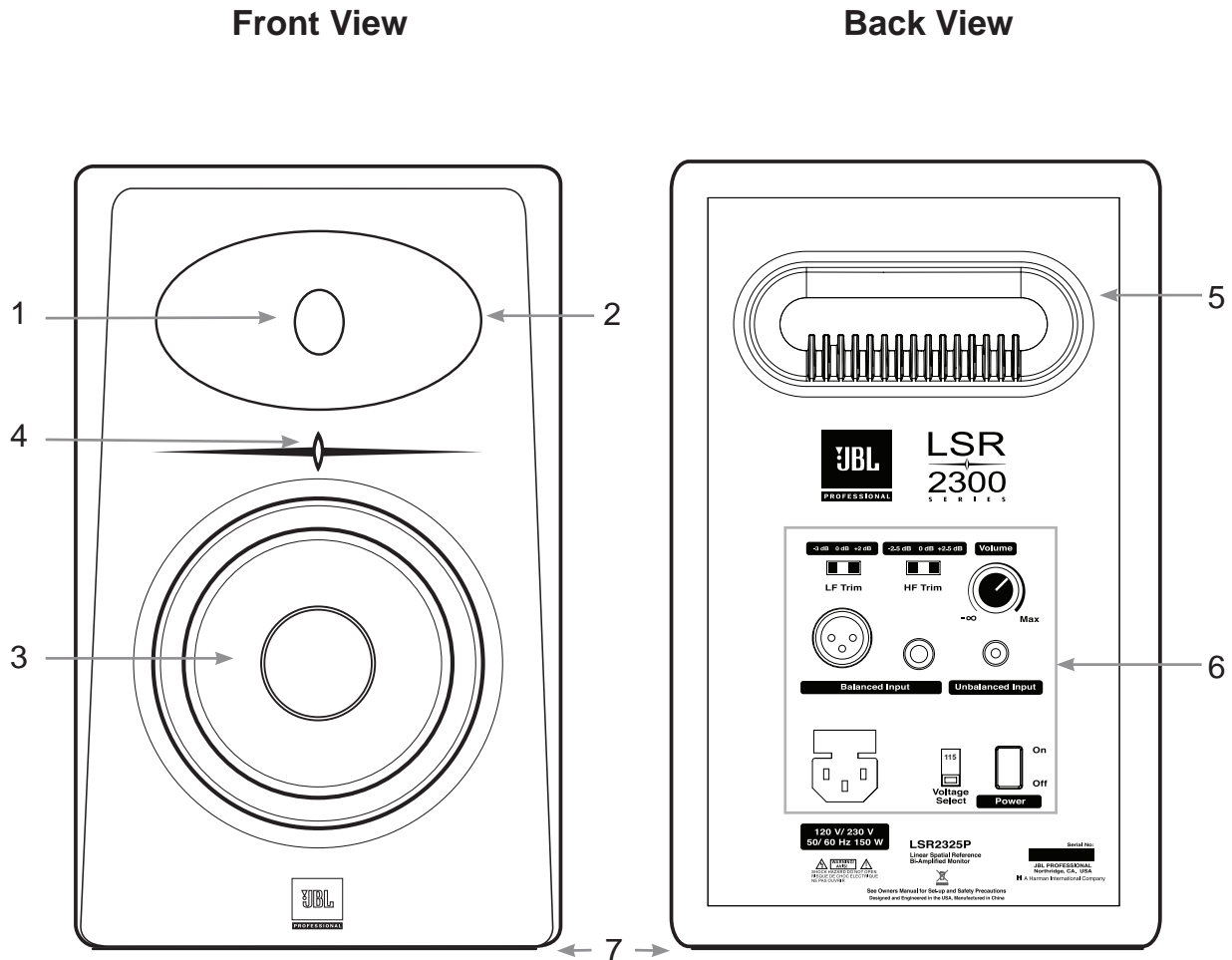

Features

1. High Frequency Transducer “Tweeter” – Reproduces high frequency signals.
2. EOS Elliptical Oblate Spheroidal Wave Guide with Elliptical Tweeter Aperture – Ensures the combination of direct and reflected sound arriving at the mix position is neutral and accurate. The Elliptical Aperture opening in the wave guide around the tweeter optimizes high frequency performance above 9 kHz.
3. Low Frequency Transducer “Woofers” – Reproduces low frequency content of the input signal.
4. Power Indicator – Illuminates when power is connected and the Power Switch is set to ON.
5. Low Frequency Port – Works in conjunction with the low frequency transducer to provide accurate low frequency performance and air flow to cool the internal electronics.
6. Input Panel – Includes input connectors, power connector and user controls.
7. Isolation Pad – The speaker is equipped with a foam pad on the bottom surface to provide acoustic isolation from the supporting surface and increase stability when the speaker is placed on a speaker stand or console top.

Input Panel

8. XLR Input – Connect professional equipment using an XLR connector.
9. 1/4" Input - Connect equipment using a 1/4" balanced or unbalanced connector.
10. RCA Input – Connect consumer equipment using an RCA input.
11. Volume Control – Use this control to set the maximum listening level.
12. High Frequency Trim – Allows boost or cut of High Frequency output by +/- 2.5dB
13. Low Frequency Trim – Allows a 2 dB boost of low frequency output by or 3 dB attenuation of low frequency output.
14. Power Connector –
15. Fuse Holder – Includes a user replaceable fuse and a spare fuse.
16. Voltage Selector – sets the operating voltage for compatibility with the voltage supply in the country of use.
17. Power Switch – Activates power for the system.

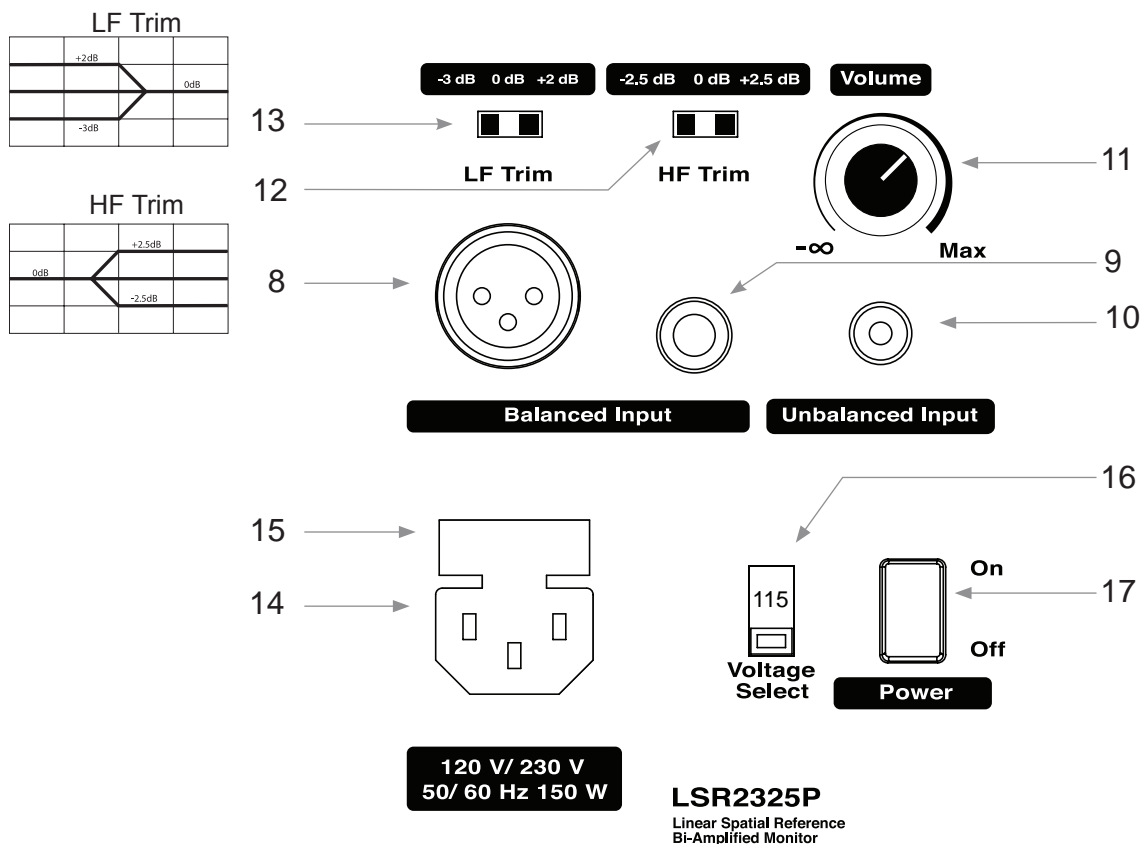

Audio Connections

Connect Professional +4dBu and -10 dBV signal sources to either the XLR or 1/4" input connectors. Connect consumer -10dBV level equipment to the RCA input connectors. Connect only a single signal source to the speaker using either XLR input connector, OR the 1/4" TRS input connector OR the RCA input connector. Do not connect multiple signal sources to multiple inputs of the same speaker simultaneously.

Section 5: LSR2310SP Powered Studio Subwoofer

Front View

Back View

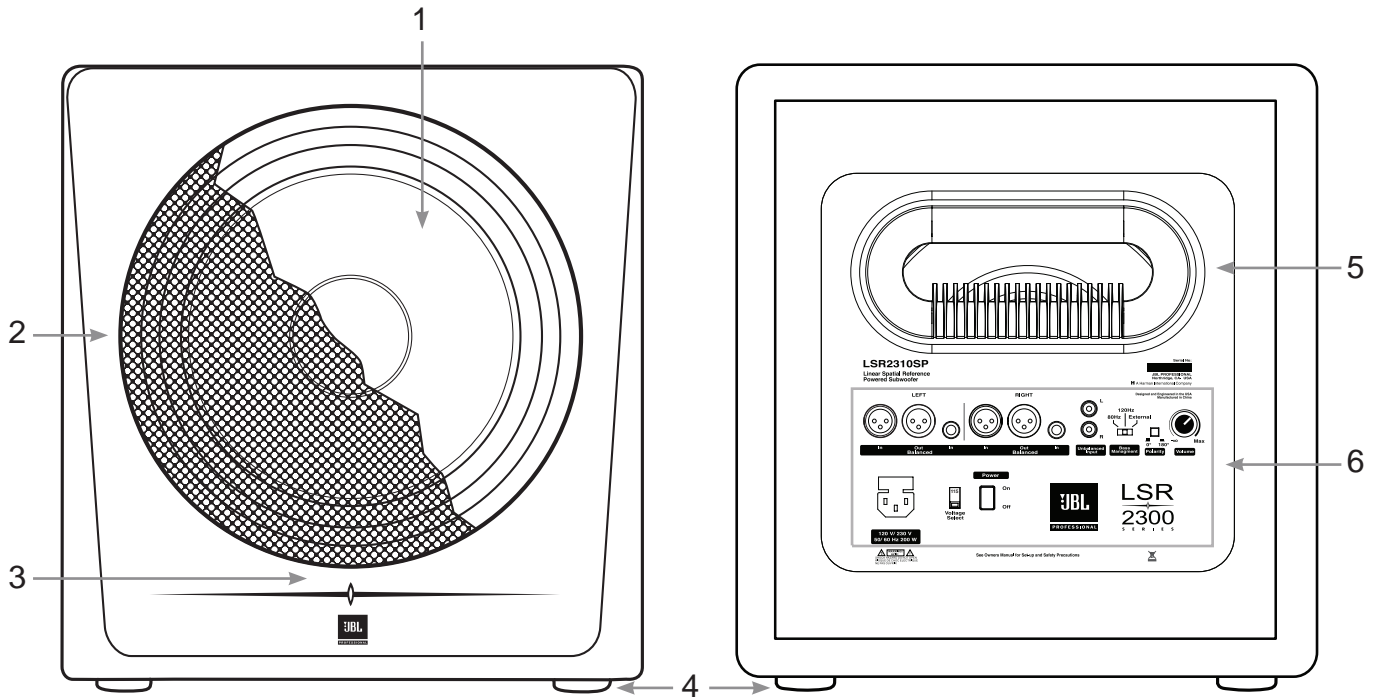

Features

1. Low Frequency Transducer “Woofers” – Reproduces low frequency signals.
2. Protective Grille – Protects the woofer when the subwoofer is placed in a location where the woofer could be damaged by feet or objects.
3. Power Indicator – Illuminates when power is connected and the Power Switch is set to ON.
4. Feet – Elevates the Subwoofer to prevent acoustic coupling with the floor and prevent scratching of the enclosure.
5. Low Frequency Port – Works in conjunction with the low frequency transducer to provide accurate low frequency performance and air flow to cool the internal electronics.
6. Input Panel - Includes input connectors, power connector and user controls.

Input Panel

7. XLR Left and Right Inputs
8. 1/4" Left and Right Inputs
9. RCA Left and Right Inputs
10. XLR Left and Right Outputs
11. Crossover Frequency Selector – Allows selection of the crossover frequency: 80Hz, 120Hz or using the External setting enables use of an outboard bass management crossover.
12. Polarity Switch – Enables optional 180 degree reversal of the subwoofer output to optimize the blend of the subwoofer with the main speakers.
13. Volume Control – Controls the subwoofer level to balance the subwoofer with the system.
14. Power Connector
15. Fuse Holder – Includes a user replaceable fuse and a spare fuse.
16. Voltage Selector – sets the operating voltage for compatibility with the voltage supply in the country of use.
17. Power Switch – Activates power for the subwoofer

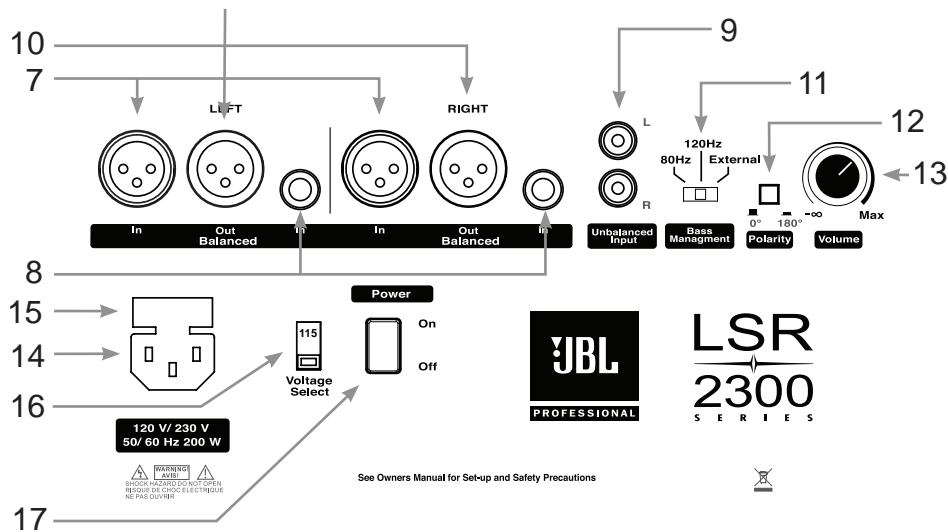

Audio Connections

Two Channel Stereo Systems: Connect the Left and Right outputs of the signal sources directly to the Left and Right Inputs of the LSR2310SP Subwoofer. Then connect the Left and Right Outputs of the Subwoofer to the Left and Right main speakers.

Using the LSR2310SP in a Surround Sound System – If the LSR2310SP Subwoofer is being used to reproduce the .1 LFE channel in a surround sound system, connect the .1 LFE signal to either the Left or Right input of the subwoofer.

Connect Professional +4dBu and -10 dBV signal sources to either the XLR or 1/4" input connectors. Connect consumer -10dBV level equipment to the RCA input connectors. Connect only a single signal source to the Left Input and a single signal source to the Right Input of the subwoofer using either XLR input connectors, OR 1/4" input connectors OR the RCA input connectors. Do not connect multiple signal sources to either the Left inputs of the subwoofer or multiple input sources to the Right inputs simultaneously.

Setting the Subwoofer Level

When the LSR2310SP Subwoofer is used in a system with LSR2328P or LSR2325 speakers, the ideal balance is achieved when the position of the volume control on the subwoofer is set to the same position as the volume control on the main speakers. However, if more or less subwoofer volume is desired, you may use the volume control on the subwoofer to achieve the balance that works best for your application and taste.

Placement and Polarity Setting

Because the human ear cannot easily recognize where low frequencies are originating from (they are said to be “non-directional”), subwoofer placement is not nearly as critical as main channel speaker positioning. The LSR2310SP is designed to be placed directly on the floor and not elevated or mounted in any way. Set this switch to the setting that yields a stronger perceived bass response at the mix position.

The subwoofer should optimally be placed somewhere between the two main speakers. Precise central placement is not necessary. Centered positioning in the room can sometimes cause unwanted cancellation, so it is recommended that the subwoofer be placed slightly off-center and not at the midpoint between the left and right walls.

Ideally, the subwoofer should be placed somewhere near, or behind, the front Center channel speaker.

Crossover Settings and “Bass Management”

“Bass management” is a term that refers to the practice of using a subwoofer to reproduce the bass frequencies of the main channels. Because of the physiology of the human ear, low frequencies are largely non-directional. Given an adequate listening distance, we can’t easily tell where bass signals are coming from. Thus, it makes little or no difference to the listening experience whether the bass component in a sound comes from the originating speaker (which may be off to your left or right, or even behind you) or from a dedicated subwoofer which is better equipped – and better positioned in the room – to reproduce low frequencies than even a full-range monitor. For that reason, you may want to use an LSR2310SP subwoofer to reproduce all the bass frequencies in your system. If you are using an LSR2310SP Subwoofer in your system, bass management is accomplished simply by routing your Left and Right mix channels to the Subwoofer inputs and then from the subwoofer outputs to the Left and Right speakers. The frequency at which the Subwoofer divides signals to the sub and the left and right speakers can be set using the Crossover Frequency selector switch on the input panel of the LSR2310SP Subwoofer. Normally this should be set to 80Hz. Two additional settings are provided:

120Hz: Many home theater and music playback systems include small speakers that are unable to reproduce low frequencies without the help of a subwoofer. In these systems, the receiver engages electronic bass management to direct low frequency content in the main channels to the subwoofer. The LSR2310SP Subwoofer includes a 120 Hz crossover setting to simulate the sound a listener might hear at home, using a system with small speakers and a subwoofer.

External: Select this setting when connecting the subwoofer to the JBL MSC1 Monitor System Controller or an external bass management system. When external is selected, XLR left and right outputs are disabled.

Surround Sound Systems and LFE

The LSR2310SP Subwoofer can be used to reproduce the LFE (Low Frequency Effects) or .1 channel in a surround sound system. In film production applications, the LFE channel contains low frequency effects, such as the sounds of explosions, and other sounds with strong low frequency components. In music applications, the LFE channel usually contains low frequency instruments such as bass, bass drum, and synthesizer elements.

Section 6: System Connections

Two Channel Systems

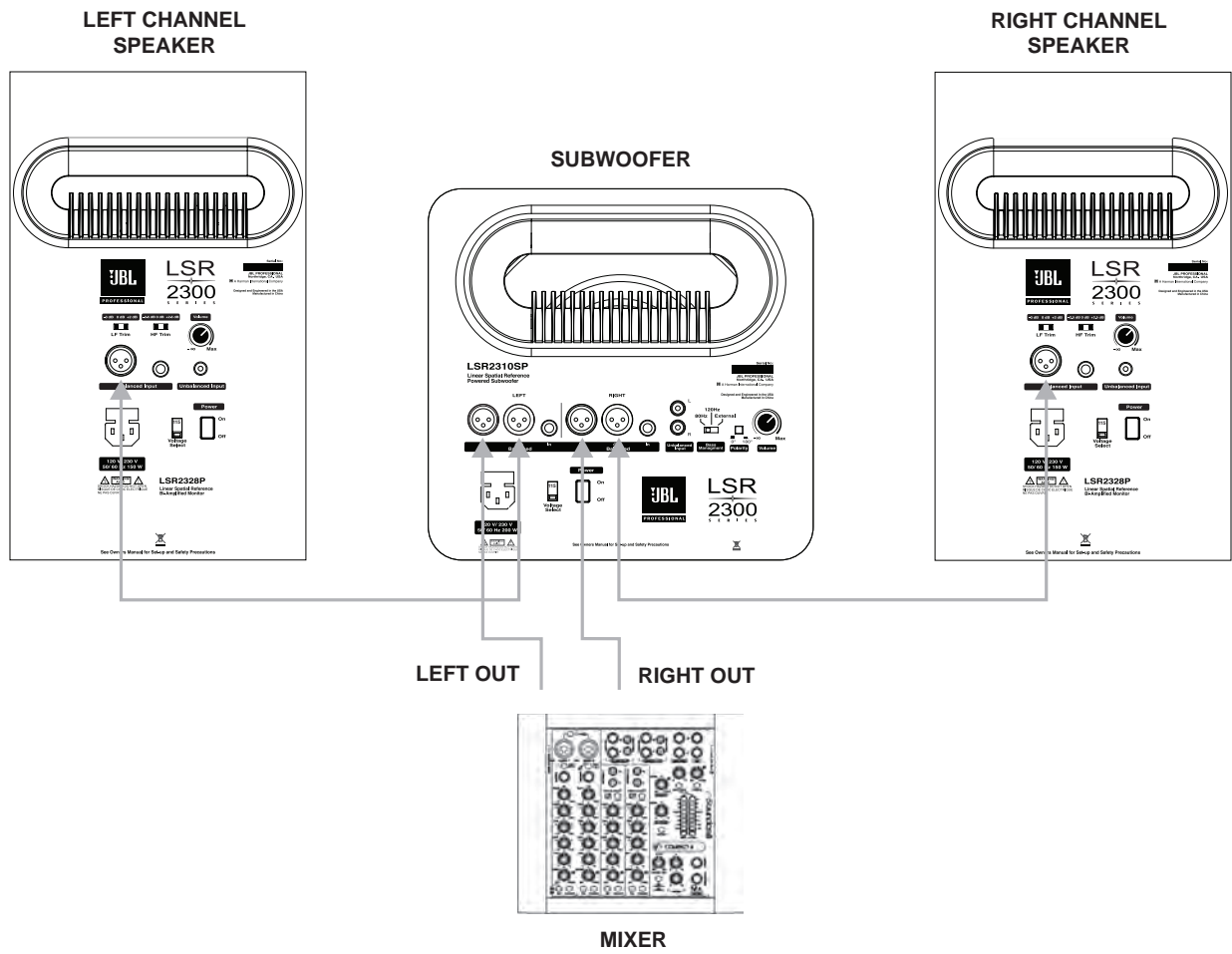

Section 6: System Connections

Two Channel Systems with MSC1 Monitor System Controller

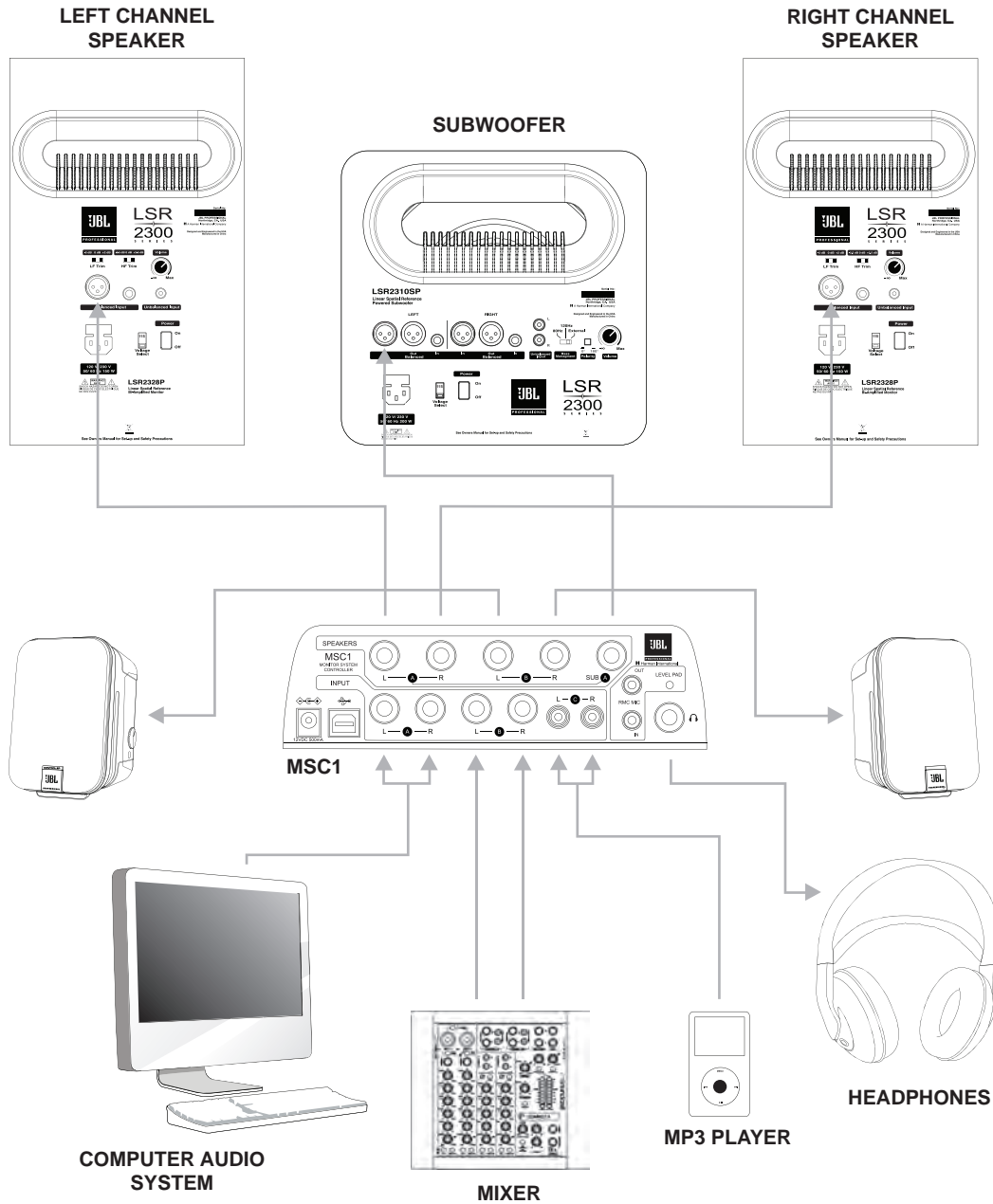

Section 6: System Connections

Surround Sound Systems

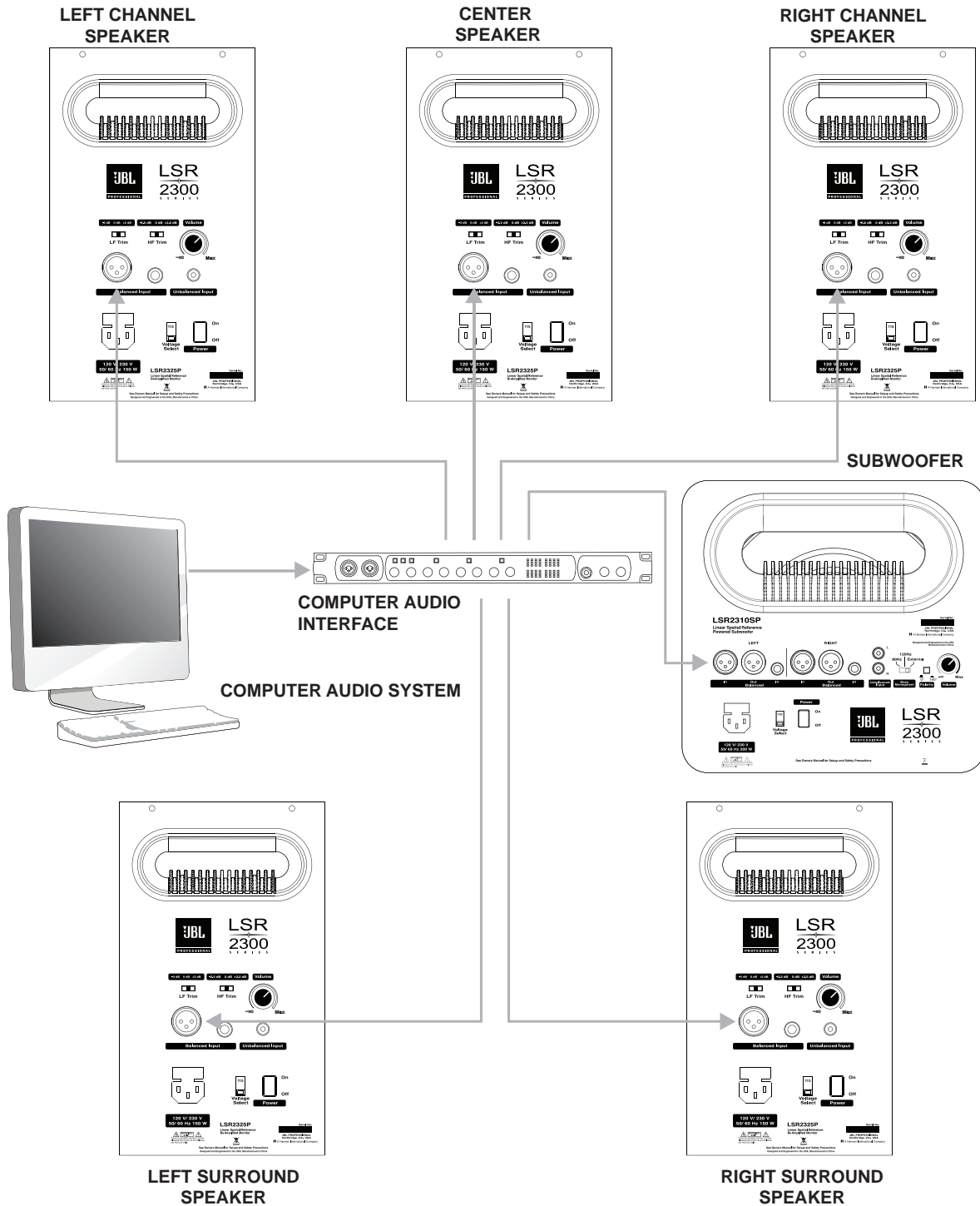

Section 8: Appendix A

Mounting Specifications for LSR2328P and LSR2325P

Mounting points are provided for use with industry-standard mounting brackets. Mounting points are located on the bottom of the LSR2328P and LSR2325P models.

Fastener specifications:

Type: M6 metric thread

Length: 1.5 inch (38.1 mm) plus the thickness of the mounting plate.

Hole Pattern:

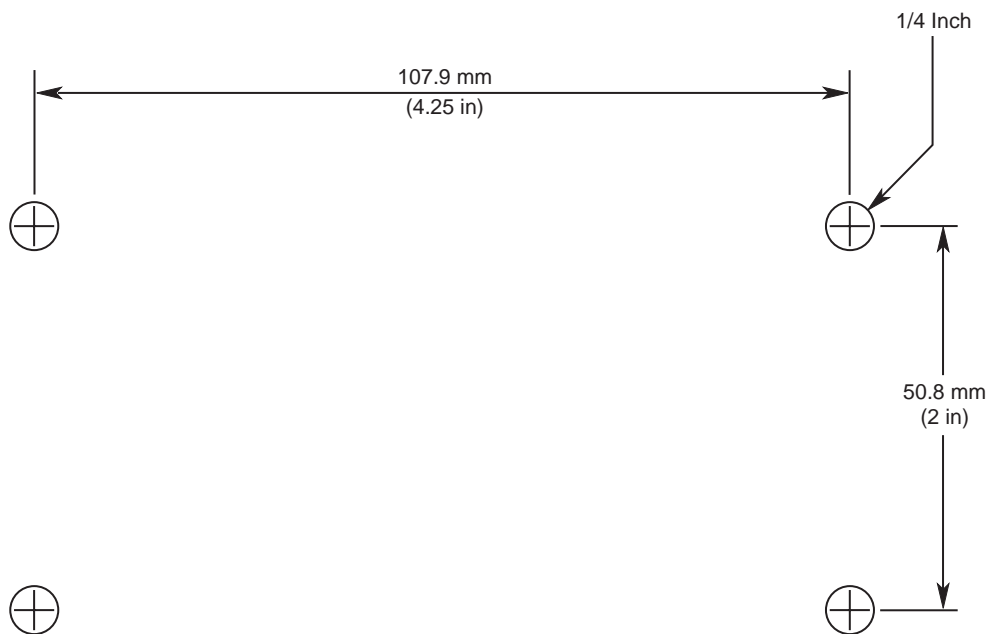

Caution: Unsafe mounting or overhead suspension of any heavy load can result in serious injury and equipment damage. Mounting of speakers should be done by qualified persons in accordance with all applicable local safety and construction standards. Be certain to follow the instructions provided by the manufacturer of the mounting bracket, be certain that it is capable of supporting the weight of the speaker to be mounted.

Section 9: Appendix B

Trouble Shooting

If there is no sound from your speakers, check these settings:

- Make sure a signal source is connected and producing sound.
- Make sure the blue power ON LED is illuminated on the front of the speaker.
- Make sure the volume control is not set to the full counter clockwise position.
- Confirm the power cable is connected and the power switch is set to the ON position.
- If the blue LED on the front of the speaker does not illuminate, examine the fuse for possible failure of the fuse. Turn the Power Switch to the OFF position. Remove the power cord and remove the fuse holder as illustrated. Examine the fuse. If the fuse has a discontinuity in the internal wire or the fuse glass has dark spots as evidence the fuse has failed, install a new fuse using the spare included in the fuse holder. Replace the fuse holder and try to re-power the system. If the system does not re-power, please contact JBL Professional Customer Service.
- When using the LSR2310SP Subwoofer: If the system sounds as if it lacks low frequency confirm the subwoofer is powered ON and the volume control is not set to full counter clockwise setting.

If the above measures do not correct the problem, please contact JBL Professional Customer Service.

Section 9: Appendix B

Specifications

	LSR2328P	LSR2325P	LSR2310SP
Frequency Range:	37 Hz – 20 kHz	43 Hz - 20 kHz	28 Hz - 2 kHz
Low-High Frequency Crossover:	2.0 kHz 4th-order acoustic Linkwitz-Riley	1.7 kHz 4th-order acoustic Linkwitz-Riley	
Maximum Continuous SPL each / Per Pair @ 1m	>104 dB SPL / >110dB SPL	>101 dB SPL / >107dB SPL	>104 dB SPL (35Hz-80Hz)
Maximum Peak SPL Each/ Per Pair @ 1m	>117 dB / >123 dB SPL / 1m	>112 dB / >118 dB SPL / 1m	113 dB
Input Connectors:	Balanced XLR, 1/4" tip-ring-sleeve and unbalanced RCA. Positive voltage applied to XLR pin 2 , 1/4" tip, RCA pin produces outward woofer motion	Balanced XLR, 1/4" tip-ring-sleeve and unbalanced RCA. Positive voltage applied to XLR pin 2 , 1/4" tip, RCA pin produces outward woofer motion	L&R: Balanced XLR (2), 1/4" tip-ring-sleeve (2) and unbalanced RCA (2). Positive voltage applied to XLR pin 2 , 1/4" tip, RCA pin produces outward woofer motion
Calibrated Input Sensitivity, XLR & 1/4": -10dBV	92 dB SPL / 1 m	92 dB SPL / 1 m	92 dB SPL / 1 m (80 Hz BM)
RCA Input: -22dBV	92 dB SPL / 1 m	92 dB SPL / 1 m	92 dB SPL / 1 m (80 Hz BM)
Output: Connectors:	- - -	- - -	L&R: Balanced XLR (2)
AC Input Voltage:	115 / 230 VAC, 50/60 Hz	115 / 230 VAC, 50/60 Hz	115 / 230 VAC, 50/60 Hz
AC Input Voltage Operating Range	+/- 15%	+/- 15%	+/- 15%
AC Input Connector:	IEC with User Replaceable Fuse	IEC with User Replaceable Fuse	IEC with User Replaceable Fuse
Replaceable Fuse Type (120 Volt / 240 Volt)	4 amp Time Lag 250V/ 2 amp Time Lag 250V	4 amp Time Lag 250V/ 2 amp Time Lag 250V	5 amp Time Lag 250V/ 2.5 amp Time Lag 250V
Long-Term Maximum System Power:	40 watts (IEC265-5)	21 watts (IEC265-5)	90 watts (IEC265-5)
Controls:			
Volume Range	-infinity dB - 0 dB	-infinity dB - 0 dB	-infinity dB - 0 dB
High Frequency Control (7 kHz Shelving):	+2.5 dB, 0 dB, -2.5 dB	+2.5 dB, 0 dB, -2.5 dB	- - -
Low Frequency Control (120 Hz Shelving):	+2.0 dB, 0 dB, -3.0 dB	+2.0 dB, 0 dB, -3.0 dB	- - -
Crossover Frequency			80 Hz, 120 Hz, External
Transducers:			
Low Frequency Model:	238G	235G	230H
Diameter:	203 mm (8 in)	132 mm (5.2 in)	254 mm (10 in)
Voice Coil:	38 mm (1.5 in)	25 mm (1.0 in)	51 mm (2.0 in)
Magnet Type:	Magnetically Shielded Ferrite	Magnetically Shielded Ferrite	Magnetically Shielded Ferrite
Cone Type:	Tempered Paper with Butyl Rubber Compliance	Tempered Paper with Butyl Rubber Compliance	Tempered Paper with Butyl Rubber Compliance
Impedance:	4 ohms	4 ohms	8 ohms
High Frequency Model:	231H	231H	- - -
Diameter:	25 mm (1 in) diaphragm	25 mm (1 in) diaphragm	- - -
Magnet Type:	Neodymium	Neodymium	- - -
Diaphragm Type:	Silk Substrate with Epoxy	Silk Substrate with Epoxy	- - -
Other Features:	EOS Elliptical Oblate Spheroidal waveguide with Elliptical Aperture	EOS Elliptical Oblate Spheroidal waveguide with Elliptical Aperture	- - -
Impedance:	8 ohms	8 ohms	- - -
Amplifier:			
Low Frequency:			
Topology:	Class A-B, monolithic	Class A-B, monolithic	Bridged Class A-B, monolithic
Sine Wave Power Rating:	95 watts (<0.1% THD into rated impedance)	55 watts (<0.1% THD into rated impedance)	180 watts (<0.1% THD into rated impedance)
THD + N, H Power:	<0.03%	<0.01%	<0.05%
High Frequency:			
Topology:	Class A-B, monolithic	Class A-B, monolithic	- - -
Sine Wave Power Rating:	70 watts (<0.1% THD into rated impedance)	35 watts (<0.1% THD into rated impedance)	- - -

Section 9: Appendix B

Specifications (Continued)

THD + N, H Power: <0.07% <0.05% - - -

Physical:

Finish:	Baffle: Metallic Anthracite Paint Enclosure: Matte Black PVC	Baffle: Metallic Anthracite Paint Enclosure: Matte Black PVC	Baffle: Metallic Anthracite Paint Enclosure: Matte Black PVC
Mounting:	4 threaded mounting points conforming to Industry-standard pattern, 107.9 x 50.8 mm (4.25 x 2.00 in) center to center. M6 metric threads.	4 threaded mounting points conforming to Industry-standard pattern, 107.9 x 50.8 mm (4.25 x 2.00 in) center to center. M6 metric threads.	- - -
Enclosure Volume (net):	13 liter (0.46 cu. ft.)	7.1 liter (0.25 cu. ft.)	34 liter (1.2 cu. ft.)
Low Frequency Vent:	Rear ported - (integrated with amplifier heat sink)	Rear ported - (integrated with amplifier heat sink)	Rear ported - (integrated with amplifier heat sink)
Baffle Construction:	Injection-molded structural ABS	Injection-molded structural ABS	Injection-molded structural ABS
Enclosure Construction:	18 mm (3/4 in) MDF	15 mm (5/8 in) MDF	18 mm (3/4 in) MDF
Net Weight:	12.7 kg (28 lb)	7.7 kg (16 lb)	20.7 kg (45.5 lb)
Dimensions (W x H x D):	397 mm x 254 mm x 335 mm (15.6 in x 10 in x 13.2 in)	303 mm x 187 mm x 258 mm (11.9 in x 7.4 in x 10 in)	414 mm x 381 mm x 460 mm (16.3 in x 15 in x 18.1 in)

Section 10: Contact Information



Mailing Address:

JBL Professional
8500 Balboa Blvd.
Northridge, CA 91329

Shipping Address:

JBL Professional
8370 Balboa Blvd., Dock D
Northridge, CA 91329

(Do not return product to this address without first obtaining prior authorization from JBL)

Customer Service:

Monday through Friday
8:00am - 5:00pm
Pacific Coast Time in the U.S.A.
(800) 8JBLPRO (800.852.5776)
www.jblproservice.com

Product Registration:

Register your product online at www.jblpro.com/registration

On The World Wide Web:

www.jblpro.com

Professional Contacts, Outside the USA:

Contact the JBL Professional Distributor in your area. A complete list of JBL Professional international distributors is provided at our U.S.A. website: www.jblpro.com

En Dehors des Etats-Unis:

Contactez votre Distributeur JBL Professional. Une liste complète de nos distributeurs internationaux est disponible sur le site web - www.jblpro.com

International:

Wenden Sie sich an Ihre örtliche JBL Professional Vertretung. Eine vollständige Liste der internationalen JBL-Vertretungen finden Sie auf unserer Website unter www.jblpro.com

Fuera de los Estados Unidos:

Comuníquese con el distribuidor de JBL Professional de su zona. En nuestro sitio web, www.jblpro.com, encontrará una lista completa de los distribuidores de JBL International.

Section 11: Warranty Information

The JBL Limited Warranty on professional loudspeaker products (except for enclosures) remains in effect for five years from the date of the first consumer purchase. JBL amplifiers are warranted for three years from the date of original purchase. Enclosures and all other JBL products are warranted for two years from the date of original purchase.

Who Is Protected By This Warranty?

Your JBL Warranty protects the original owner and all subsequent owners so long as: A.) Your JBL product has been purchased in the Continental United States, Hawaii or Alaska. (This Warranty does not apply to JBL products purchased elsewhere except for purchases by military outlets. Other purchasers should contact the local JBL distributor for warranty information.); and B.) The original dated bill of sale is presented whenever warranty service is required.

What Does The JBL Warranty Cover?

Except as specified below, your JBL Warranty covers all defects in material and workmanship. The following are not covered: Damage caused by accident, misuse, abuse, product modification or neglect; damage occurring during shipment; damage resulting from failure to follow instructions contained in your Instruction Manual; damage resulting from the performance of repairs by someone not authorized by JBL; claims based upon any misrepresentations by the seller; any JBL product on which the serial number has been defaced, modified or removed.

Who Pays For What?

JBL will pay all labor and material expenses for all repairs covered by this warranty. Please be sure to save the original shipping cartons because a charge will be made if replacement cartons are requested. Payment of shipping charges is discussed in the next section of this warranty.

How To Obtain Warranty Performance

If your JBL product ever needs service, write or telephone us at JBL Incorporated (Attn: Customer Service Department), 8500 Balboa Boulevard, PO. Box 2200, Northridge, California 91329 (818/893-8411). We may direct you to an authorized JBL Service Agency or ask you to send your unit to the factory for repair. Either way, you'll need to present the original bill of sale to establish the date of purchase. Please do not ship your JBL product to the factory without prior authorization. If transportation of your JBL product presents any unusual difficulties, please advise us and we may make special arrangements with you. Otherwise, you are responsible for transporting your product for repair or arranging for its transportation and for payment of any initial shipping charges. However, we will pay the return shipping charges if repairs are covered by the warranty.

Limitation of Implied Warranties

ALL IMPLIED WARRANTIES, INCLUDING WARRANTIES OF MERCHANTABILITY AND FITNESS FOR PARTICULAR PURPOSE, ARE LIMITED IN DURATION TO THE LENGTH OF THIS WARRANTY.

EXCLUSION OF CERTAIN DAMAGES

JBL'S LIABILITY IS LIMITED TO THE REPAIR OR REPLACEMENT, AT OUR OPTION, OF ANY DEFECTIVE PRODUCT AND SHALL NOT INCLUDE INCIDENTAL OR CONSEQUENTIAL DAMAGES OF ANY KIND. SOME STATES DO NOT ALLOW LIMITATIONS ON HOW LONG AN IMPLIED WARRANTY LASTS AND/OR DO NOT ALLOW THE EXCLUSION OF INCIDENTAL OR CONSEQUENTIAL DAMAGES, SO THE ABOVE LIMITATIONS AND EXCLUSIONS MAY NOT APPLY TO YOU. THIS WARRANTY GIVES YOU SPECIFIC LEGAL RIGHTS, AND YOU MAY ALSO HAVE OTHER RIGHTS, WHICH VARY, FROM STATE TO STATE.

JBL Professional
8500 Balboa Boulevard
Northridge, CA 91329 USA
 Harman International

01/2009 Visit us online at www.jblpro.com



Part Number: 365438-001
Rev 0709